

FLseries energy power batteries



Introduce

TCSN FL series utilizes high-rate, long-life LFP batteries and features a built-in, high-quality BMS. Compared to traditional lead-acid batteries, these lithium batteries demonstrate exceptional performance and longevity, while also offering superior charging capabilities; they are widely applicable across a variety of scenarios, such as low-speed electric vehicles and sightseeing shuttles.

Features

- Shock-resistant design**
 Automotive-Grade Vibration-Resistant Design
 Unafraid of Bumps — Rock-Solid Stability
- Safe and worry-free**
 Using LFP batteries ensures high safety, no fire, and no explosion.
- Worry-Free After-Sales Service**
 5-Year Standard Warranty
 Long-Lasting Protection — Extendable
- Low self-discharge**
 Significantly Reduced Power Loss During Hibernation
 Monthly Self-Discharge $\leq 2\%$
- Intelligent Management**
 Remote Backend Monitoring
 Data Management
- Environmentally Friendly**
 Practicing the Circular Economy
 Enabling Clean Operations

Performance

| Model | Dubhe FL80-420 |
|---------------------------------|-------------------|
| Performance | |
| Cell | Square LFP210Ah |
| Terminal | M8 |
| IP Grade | IP65 |
| Self Discharge | $\leq 2\%$ /Month |
| Cycle Life | 6000times(80%DOD) |
| Rated Charge Current | 100A |
| Max. Charge Current | 150A |
| Rated Charge Voltage | 85~86.25V |
| Charge Cut-off Voltage | 91.25V |
| Balancing Voltage | $>85V$ |
| Rated Discharge Current | 200A |
| Max. Discharge Current | 400A10S |
| Rated Discharge Cut-off Voltage | 70V |
| Min. Discharge Cut-off Voltage | $>62.5V$ |
| Short Circuit Current | Approx.3000A |

| Performance parameters | |
|-------------------------|-----------------------|
| Capacity | 420Ah(0.5C@25°C) |
| Nominal Voltage | 80V |
| Energy | 33600Wh |
| Weight | ~225kg |
| Dimensions | 795*690*545mm |
| Communication interface | RS485/CAN/Bluetooth |
| LCD Panel | 4.2-inch touch screen |
| Storage Temp | -5°C to 35°C |
| Discharge Temp | -20°C to 55°C |
| Charge Temp | 0°C to 45°C |

Size

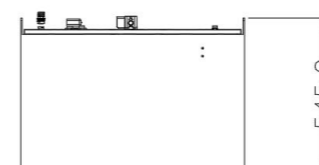
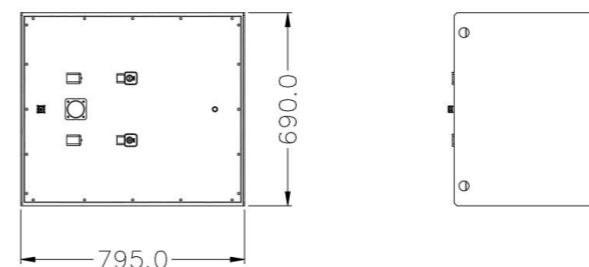

Compliance

| | |
|---------------------|----------------|
| Certifications | Cell UN38.3 |
| | Battery UN38.3 |
| Transport Appraisal | UN3480,CLASS 9 |

System Management Diagram

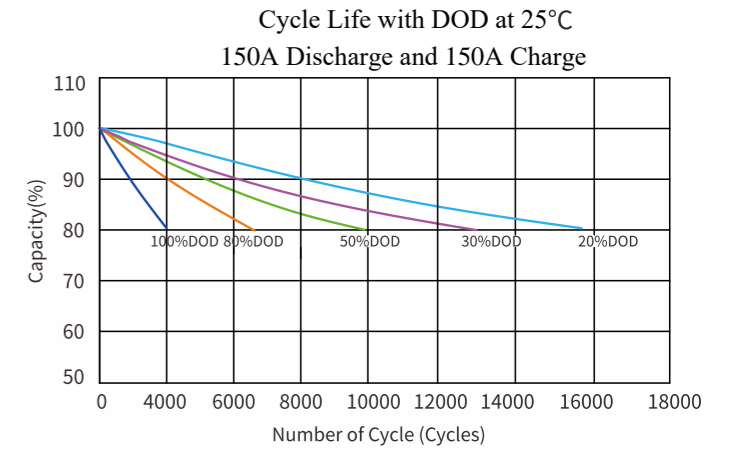
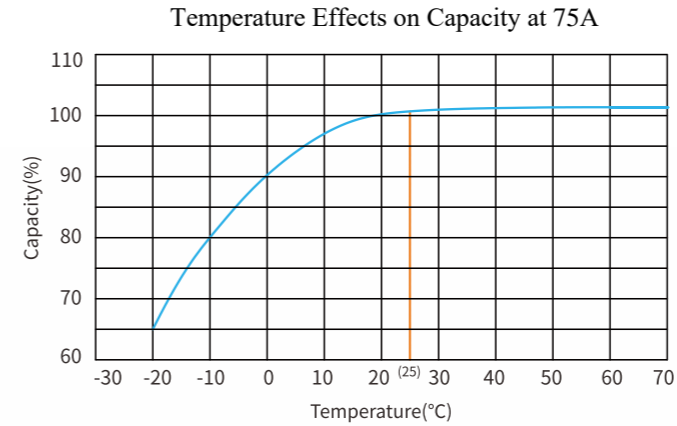

Characteristics Curve

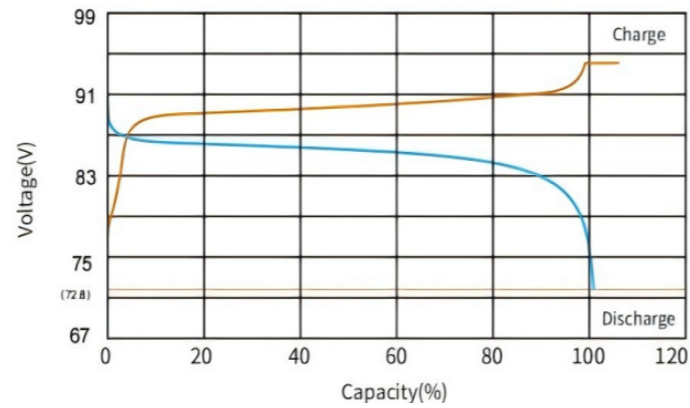
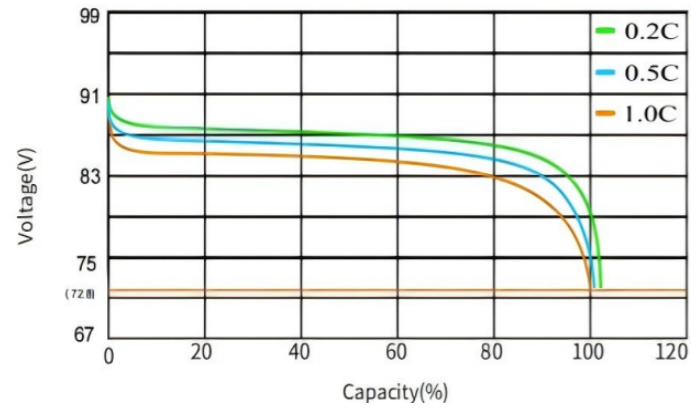

Cautions

1. Do NOT short circuit, crush or disassemble.
2. Do NOT heat or incinerate.
3. Do NOT immerse in any liquid.
4. Store at 50% capacity. Recharge every 3 months. The storage area should be clean, cool, dry and ventilated.
5. Disconnect charging source prior to connecting or disconnecting battery terminals.
6. Do not dispose of batteries in a fire as they can explode.
7. Do not open, alter, or mutilate batteries. Released electrolyte is harmful to skin and eyes. It may be toxic.
8. Do not mix different types and brands of lithium-ion batteries.
9. Do not dispose in trash, follow local regulations and manufacturer's instruction.
10. See installation instructions before connecting to the supply.
11. The battery cabinet receives power from more than one source. Disconnection of all DC sources is required to De-energize this unit before installing or servicing. Wait 5 minutes before opening the unit.
12. Do not install on or over combustible surfaces.
13. Refer to manual before servicing.
14. Do not touch bare terminals.